

972 CONESTOGA PARKWAY

Shepherdsville, KY

631,366 square feet
DISTRIBUTION FACILITY

OFFICE	Main Office - 14,580 SF Shipping Offices - (2) 1,300 SF
LOADING FACILITIES	(65) dock positions - (40) fully equipped doors expandable to (124) Cross dock load
DRIVE IN DOOR	(3) 14' x 16' drive-in doors

BUILT	2014
CLEAR HEIGHT	36'
COLUMN SPACING	50' x 50' 60' speed bays
TRUCK COURT	185' fenced front / back concrete apron
TRAILER PARKING	32 stalls
AUTO PARKING	532 spaces
CONSTRUCTION	Concrete precast
SLAB	7" concrete floors
POWER	4000 Amp, 277/480 V 3 phase
ROOF	TPO
LOT SIZE	35.9 acres



BELINDA FLORES
Director, Asset Management
469.965.3348
bflores@granitereit.com



MATT HARTLAGE, SIOR
MANAGING DIRECTOR
502.394.2517
matt.hartlage@jll.com

POWELL SPEARS
SENIOR MANAGING DIRECTOR
502.394.2509
powell.spears@jll.com

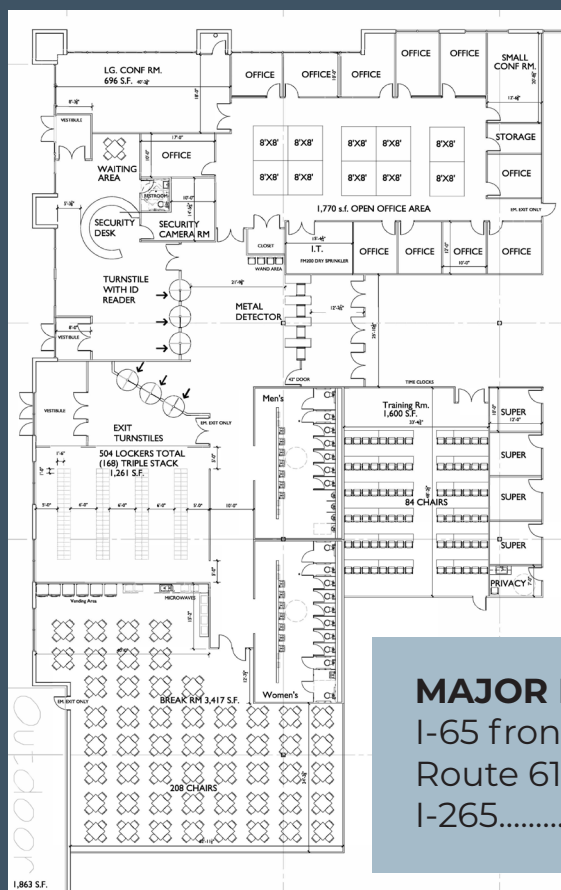
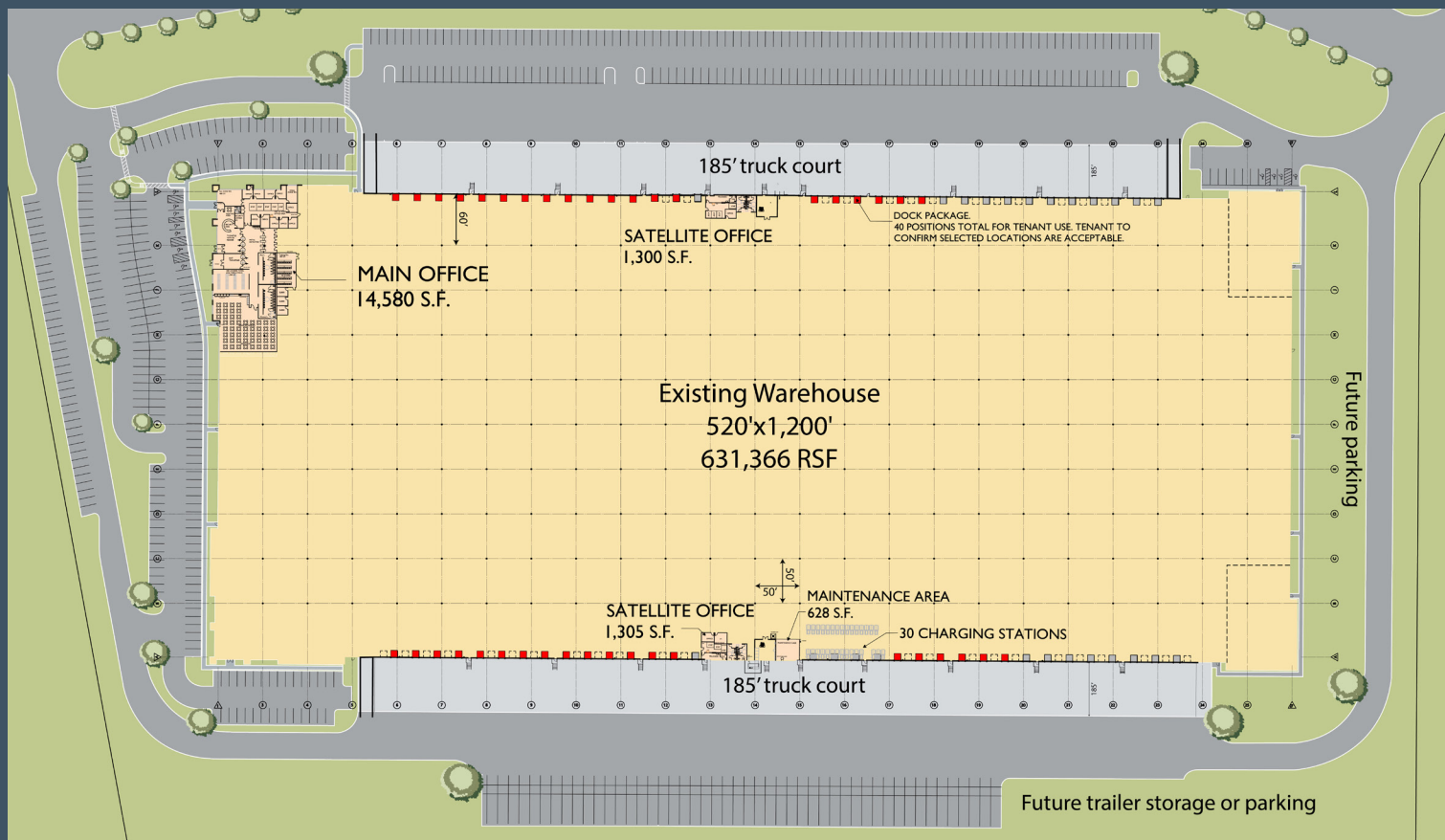

Located in Louisville, a centrally located logistics hub,

972 Conestoga Parkway is strategically positioned along I-65 frontage, with easy access to multiple interstate highways and the UPS Worldport - the world's most automated shipping facility - making it an ideal location for regional distribution.



MAJOR ROADS

I-65 frontage
Route 61.....1 mi
I-265.....9 mi

POINTS OF INTEREST

Louisville Intl Airport.....15 mi
UPS Worldport.....14 mi



BELINDA FLORES
Director, Asset Management
469.965.3348
bflores@granitereit.com



MATT HARTLAGE, SIOR
MANAGING DIRECTOR
502.394.2517
matt.hartlage@jll.com

POWELL SPEARS
SENIOR MANAGING DIRECTOR
502.394.2509
powell.spears@jll.com